

Multiple Building Property Summary

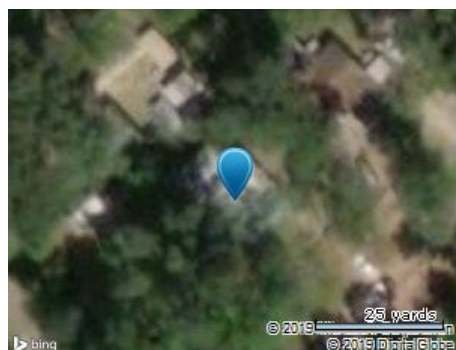

N/A	1,212	8,137	N/A
Beds	Bldg Sq Ft	Lot Sq Ft	Sale Price
1	1970	SFR	N/A
Baths	Yr Built	Type	Sale Date

Owner Information

Owner Name:	Dietz Kory K	Tax Billing City & State:	Conroe, TX
Owner Occupied:	No	Tax Billing Zip:	77303
Carrier Route:	R118	Tax Billing Zip+4:	3637
Tax Billing Address:	10911 Sandalwood St		

Location Information

Subdivision:	Lake Rollingwood 02	MLS Area:	19
School District Name:	Conroe ISD	Market Area:	CONROE NORTHEAST
Neighborhood Code:	Lake Rollingwood-16140.0	Key Map:	129t
Township:	Conroe	Census Tract:	6940.00

Tax Information

Parcel ID:	6740-02-09000	Block #:	12
Parcel ID:	R116968	% Improved:	97%
Parcel ID:	67400209000	Tax Area:	GMO
Lot #:	4-B	Fire Dept Tax Dist:	F01
Legal Description:	LAKE ROLLINGWOOD 02, BLOCK 12, LOT 4-B		

Assessment & Tax

Assessment Year	2018	2017	2016
Assessed Value - Total	\$44,570	\$44,580	\$44,590
Assessed Value - Land	\$1,460	\$1,460	\$1,460
Assessed Value - Improved	\$43,110	\$43,120	\$43,130
YOY Assessed Change (\$)	-\$10	-\$10	
YOY Assessed Change (%)	-0.02%	-0.02%	
Market Value - Total	\$44,570	\$44,580	\$44,590
Market Value - Land	\$1,460	\$1,460	\$1,460
Market Value - Improved	\$43,110	\$43,120	\$43,130

Tax Year	Total Tax	Change (\$)	Change (%)
2016	\$901		
2017	\$901	-\$0	-0.03%
2018	\$898	-\$3	-0.34%

Jurisdiction	Tax Rate	Tax Amount
Emergency Svc Dist 1	.1	\$44.57
Montgomery County	.4667	\$208.01
Montgomery Co Hospital	.0599	\$26.70
Lone Star College	.1078	\$48.05
Conroe ISD	1.28	\$570.50
Total Estimated Tax Rate	2.0144	

Characteristics

Land Use - CoreLogic:	SFR	Full Baths:	1
Land Use - County:	Sgl-Fam-Res-Home	Cooling Type:	Central
Land Use - State:	Sgl-Fam-Res-Home	Heat Type:	Central
Lot Acres:	0.1868	Porch:	Open Concrete/Masonry Porch
Lot Sq Ft:	8,137	Porch Sq Ft:	108
# of Buildings:	2	Parking Type:	Carport
Building Type:	Single Family	Garage Type:	Carport
Building Sq Ft:	1,212	Carport Sq Ft:	144
Gross Sq Ft:	1,212	Roof Material:	Composition Shingle
Above Gnd Sq Ft:	1,212	Interior Wall:	Drywall
Ground Floor Sq Ft:	1,212	Floor Cover:	Softwood
Stories:	1	Foundation:	Concrete Block
Condition:	Average	Exterior:	Frame Wood
Quality:	Fair	Year Built:	1970
Total Baths:	1	Effective Year Built:	1970

Features

Feature Type	Unit	Size/Qty	Year Built
Main Area	S	1,212	1970
Open Masonry Porch	S	108	1970
Carport	S	144	1990

Last Market Sale & Sales History

Recording Date	02/19/2015	10/29/1996
Buyer Name	Dietz Kory K	Warren Donna K
Seller Name	Warren Donna K	Davis James W & Eloise
Document Number	15039	20500-1418
Document Type	Warranty Deed	Grant Deed

Mortgage History

Mortgage Date	01/22/2001	10/29/1996
Mortgage Amount	\$25,000	\$25,000
Mortgage Lender	Gmac Mtg	
Mortgage Code	Conventional	Private Party Lender
Borrower Name	Warren Donna K	Warren Donna K

Property Map

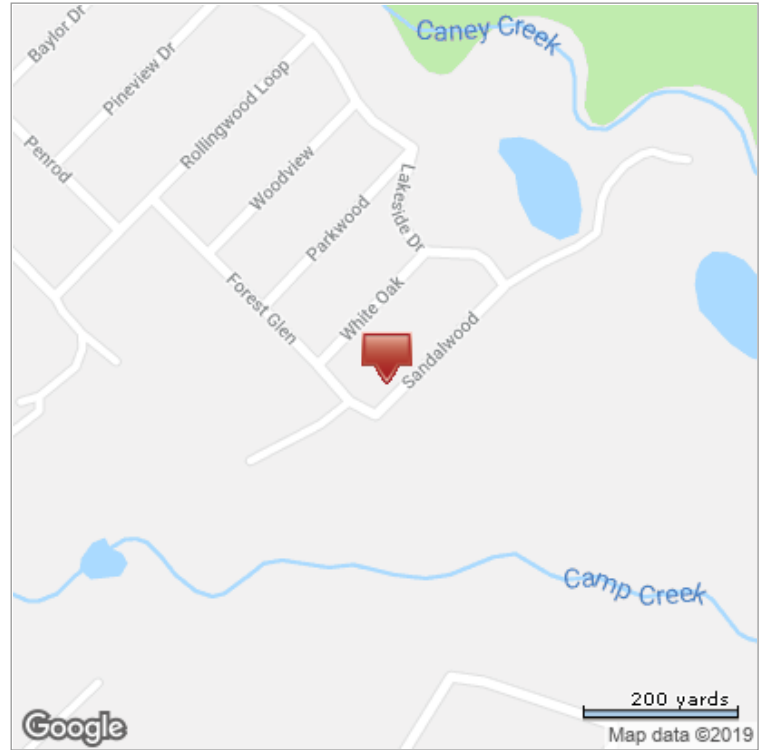
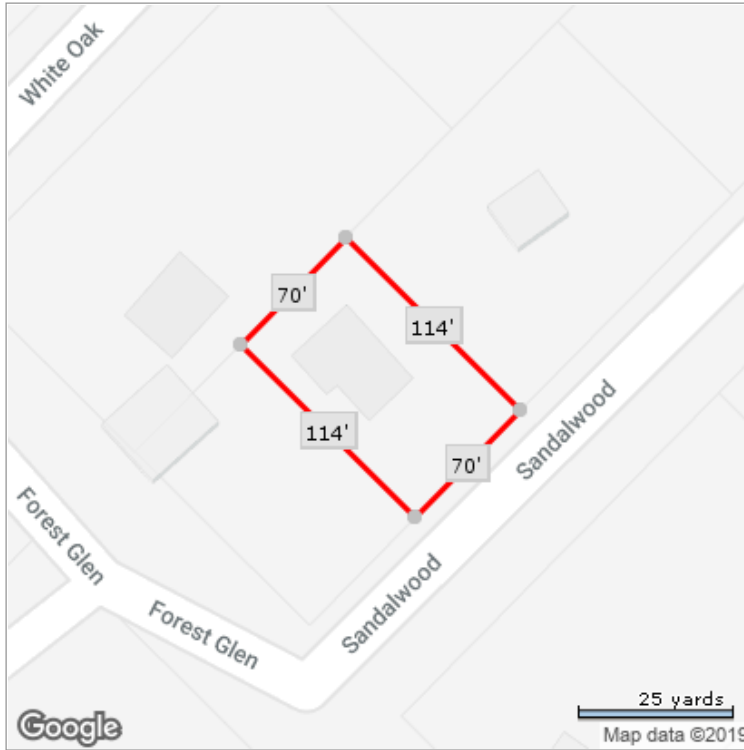

*Lot Dimensions are Estimated

Building 1 of 2

Characteristics

Land Use - CoreLogic:	SFR	Cooling Type:	Central
Land Use - County:	Sgl-Fam-Res-Home	Heat Type:	Central
Land Use - State:	Sgl-Fam-Res-Home	Porch:	Open Concrete/Masonry Porch
Lot Acres:	0.1868	Porch Sq Ft:	108
Lot Sq Ft:	8,137	Parking Type:	Carport
Building Type:	Single Family	Garage Type:	Carport
Building Sq Ft:	1,212	Carport Sq Ft:	144
Gross Sq Ft:	1,212	Roof Material:	Composition Shingle
Above Gnd Sq Ft:	1,212	Interior Wall:	Drywall
Ground Floor Sq Ft:	1,212	Floor Cover:	Softwood
Stories:	1	Foundation:	Concrete Block
Condition:	Average	Exterior:	Frame Wood
Quality:	Fair	Year Built:	1970
Full Baths:	1	Effective Year Built:	1970

Features

Feature Type	Unit	Size/Qty	Year Built
Main Area	S	1,212	1970
Open Masonry Porch	S	108	1970
Carport	S	144	1990

Building 2 of 2

Characteristics

Land Use - CoreLogic:	SFR	Lot Sq Ft:	8,137
Land Use - County:	Sgl-Fam-Res-Home	Building Type:	Single Family
Land Use - State:	Sgl-Fam-Res-Home	Gross Sq Ft:	1,212
Lot Acres:	0.1868		

Courtesy of Mayra Aponte, eXp Realty, Houston Association of REALTORS

The data within this report is compiled by CoreLogic from public and private sources. If desired, the accuracy of the data contained herein can be independently verified by the recipient of this report with the applicable county or municipality.

Property Detail

Generated on 08/12/2019

Page 3 of 4

Courtesy of Mayra Aponte, eXp Realty, Houston Association of REALTORS

The data within this report is compiled by CoreLogic from public and private sources. If desired, the accuracy of the data contained herein can be independently verified by the recipient of this report with the applicable county or municipality.

Property Detail

Generated on 08/12/2019

Page 4 of 4