

22311 Tree House Ln, Spring, TX 77373-8801, Harris County



3	1,275	3,300	N/A
MLS Beds	MLS Sq Ft	Lot Sq Ft	Sale Price
2	1982	SFR	N/A
MLS Baths	Yr Built	Type	Sale Date

Owner Information

Owner Name:	Perez Jose R	Tax Billing City & State:	Houston, TX
Owner Occupied:	No	Tax Billing Zip:	77090
Carrier Route:	C010	Tax Billing Zip+4:	1939
Tax Billing Address:	727 Oder Ln		

Location Information

Subdivision:	Timber Lane Sec 12	Waterfront Influence:	Neighborhood
School District Name:	Spring ISD	Topography:	Flat/Level
Neighborhood Code:	Timberlane 12 (Duplex)-2209.00	Census Tract:	2411.03
Township:	Spring	Map Facet:	333-B
MLS Area:	12	Traffic:	Paved
Key Map:	333b		

Tax Information

Parcel ID:	114-247-001-0020	% Improved:	84%
Parcel ID:	1142470010020	Tax Area:	040
Lot #:	20	Fire Dept Tax Dist:	550
Block #:	1	Water Tax Dist:	041
Legal Description:	TR 20A BLK 1 (024 & 847* S/2 LT 20) TIMBER LANE SEC 12		
M.U.D. Information:	847		

Assessment & Tax

Assessment Year	2018	2017	2016
Assessed Value - Total	\$60,500	\$60,500	\$60,542
Assessed Value - Land	\$9,900	\$9,900	\$9,900
Assessed Value - Improved	\$50,600	\$50,600	\$50,642
YOY Assessed Change (\$)	\$0	-\$42	
YOY Assessed Change (%)	0%	-0.07%	
Market Value - Total	\$60,500	\$60,500	\$60,542
Market Value - Land	\$9,900	\$9,900	\$9,900
Market Value - Improved	\$50,600	\$50,600	\$50,642

Tax Year	Total Tax	Change (\$)	Change (%)
2016	\$1,978		
2017	\$1,998	\$20	1.01%
2018	\$1,997	-\$2	-0.09%

Jurisdiction	Tax Rate	Tax Amount
Spring ISD	1.51	\$913.55
Harris County	.41858	\$253.24
Hc Flood Control Dist	.02877	\$17.41
Port Of Houston Authority	.01155	\$6.99
Hc Hospital Dist	.17108	\$103.50
Hc Department Of Education	.00519	\$3.14

Courtesy of Mayra Aponte, eXp Realty, Houston Association of REALTORS

The data within this report is compiled by CoreLogic from public and private sources. If desired, the accuracy of the data contained herein can be independently verified by the recipient of this report with the applicable county or municipality.

Property Detail

Generated on 08/31/2019

Page 1 of 4

N Harris-Mont College District	.1078	\$65.22
Hc Emerg Srv Dist 7	.09606	\$58.12
Hc Emerg Srv Dist 11	.03606	\$21.82
Timber Lane Ud	.915	\$553.58
Total Estimated Tax Rate	3.3001	

Characteristics

Land Use - CoreLogic:	SFR	MLS Total Baths:	2
Land Use - County:	Res Imprvd Table Val	Full Baths:	2
Land Use - State:	Resid Single Family	Fireplace:	Y
Lot Acres:	0.0758	Fireplaces:	1
Lot Sq Ft:	3,300	Elec Svs Type:	Y
# of Buildings:	1	Cooling Type:	Central
Building Type:	Single Family	Heat Type:	Central
Bldg Class:	R	Porch:	Open Frame Porch
Building Sq Ft:	1,275	Porch Sq Ft:	54
Gross Sq Ft:	1,275	Patio/Deck 2 Area:	32
Above Gnd Sq Ft:	1,275	Parking Type:	On & Off Street
Ground Floor Sq Ft:	1,275	Garage Type:	Parking Avail
Stories:	1	Foundation:	Slab
Condition:	Average	Exterior:	Frame Concrete Block/Brick
Quality:	Average	Year Built:	1982
Total Rooms:	5	Building Remodel Year:	2017
Bedrooms:	3	Effective Year Built:	1982
Total Baths:	2		

Features

Feature Type	Unit	Size/Qty
Base Area Pri	S	1,275
Open Frame Porch Pri	S	54
Open Frame Porch Pri	S	32

Building Description	Building Size
Fireplace: Metal	1
Fixtures: Addl	2
Fixtures: Total	10
Room: Bedroom	3
Room: Full Bath	2
Room: Total	5
Story Height Index	1

Listing Information

MLS Listing Number:	82235578	MLS Pending Date:	08/21/2015
MLS Status:	Sold	MLS Sale Date:	08/29/2015
Listing Area:	12	MLS Sale/Close Price:	\$1,000
MLS D.O.M.:	14	Listing Agent:	Market-Ann Koelling
MLS Listing Date:	08/07/2015	Listing Broker:	ANN KOELLING PROPERTIES
MLS Current List Price:	\$1,000	Selling Agent:	Lgaffney-Lakendra Gaffney
MLS Original List Price:	\$1,000	Selling Broker:	SAPPHIRE REALTY
MLS Status Change Date:	09/01/2015		

MLS Listing #	63046695	66620114	89349266	86949682	45803712
MLS Status	Sold	Expired	Sold	Sold	Terminated
MLS Listing Date	08/20/2014	09/11/2013	11/15/2011	08/03/2011	04/11/2011
MLS Listing Price	\$900	\$50,000	\$800	\$37,900	\$44,900
MLS Orig Listing Price	\$900	\$65,000	\$900	\$37,900	\$51,000
MLS Sale Date	09/21/2014		02/12/2012	09/16/2011	
MLS Sale Price	\$900		\$800	\$36,000	
MLS Wthdr Date					06/23/2011

Courtesy of Mayra Aponte, eXp Realty, Houston Association of REALTORS

The data within this report is compiled by CoreLogic from public and private sources. If desired, the accuracy of the data contained herein can be independently verified by the recipient of this report with the applicable county or municipality.

Property Detail

Generated on 08/31/2019

Page 2 of 4

MLS Listing #	2851108	90834608	2082612
MLS Status	Terminated	Terminated	Expired
MLS Listing Date	12/17/2010	09/14/2010	06/01/2007
MLS Listing Price	\$59,000	\$800	\$75,000
MLS Orig Listing Price	\$59,000	\$950	\$75,000
MLS Sale Date			
MLS Sale Price			
MLS Wthdr Date	01/03/2011	01/03/2011	

Last Market Sale & Sales History

Recording Date	09/20/2011	08/08/2011	03/07/2011	05/16/2005	11/09/2001
Buyer Name	Perez Joe	G8 Opportunity Fund VI LLC	Federal Natl Mtg Assn Fnma	Garner Sheila R	Welsh Byron & Cory
Buyer Name 2					Welsh Cory
Seller Name	G8 Opportunity Fund VI LLC	Federal Natl Mtg Assn Fnma	Reder T	Welsh Byron & Candace C	Khan Nadeem A & Tina W
Document Number	395987	328589	93204	Y469578	54575-748
Document Type	Special Warranty Deed	Special Warranty Deed	Trustee's Deed (Foreclosure)	Warranty Deed	Warranty Deed
Recording Date	10/25/2001	07/15/1997	06/26/1997		
Buyer Name	Welsh Byron & Cory	Khan Nadeem A & Tina H	T & E Investments Inc		
Buyer Name 2	Welsh Cory	Khan Tina H			
Seller Name	Burkhardt Jason & Angela	T & E Investments	Sadler Richard C		
Document Number	54524-1001	51390-1447	51361-2948		
Document Type	Warranty Deed	Grant Deed	Grant Deed		

Mortgage History

Mortgage Date	05/16/2005	11/09/2001	11/09/2001	10/25/2001	07/15/1997
Mortgage Amount	\$63,000	\$50,000	\$12,500	\$61,965	\$36,000
Mortgage Lender	Bank Of America	Sterling Cap Mtg Co	Sterling Cap Mtg Co	Sterling Cap Mtg Co	
Mortgage Code	Conventional	Conventional	Conventional	Fha	Private Party Lender
Borrower Name	Garner Sheila R	Welsh Byron	Welsh Byron	Welsh Byron	Khan Nadeem A
Borrower Name 2		Welsh Cory	Welsh Cory	Welsh Cory	Khan Tina H

Property Map

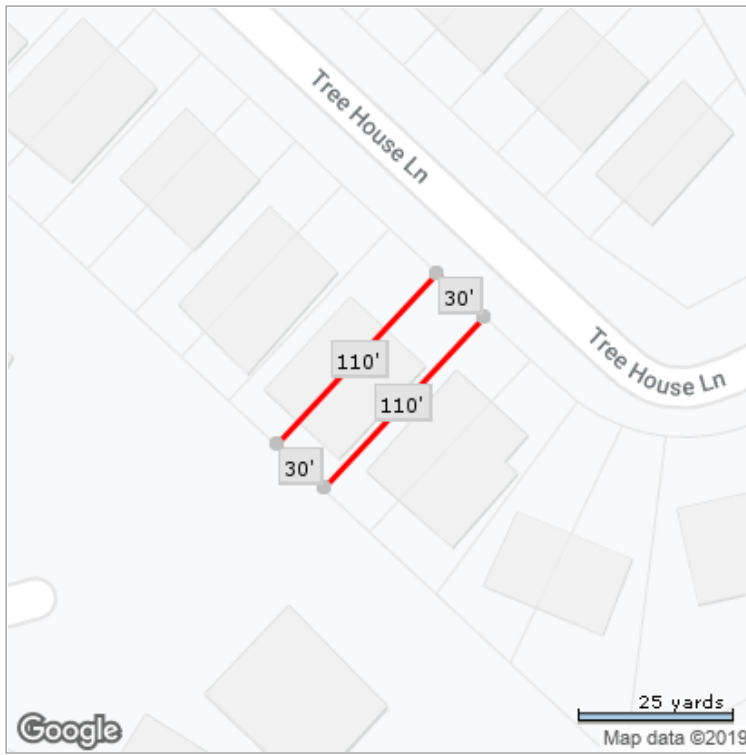

*Lot Dimensions are Estimated